

## OSTH-Oval Stack Head, Galvanized

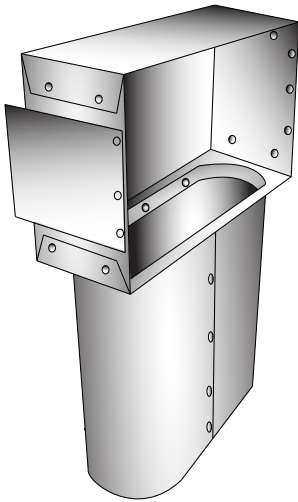

Model	Description
OSTH4104	Galv. Oval Stackhead Boot, 4"x10"x4" Oval (10.1x25.4x10.1 cm) x8"(20.3cm) long pipe
OSTH4105	Galv. Oval Stackhead Boot, 4"x10"x5" Oval (10.1x25.4x10.1 cm) x8"(20.3cm) long pipe
OSTH4016	Galv. Oval Stackhead Boot, 4"x10"x6" Oval (10.1x25.4x10.1 cm) x8"(20.3cm) long pipe
OSTH4126	Galv. Oval Stackhead Boot, 4"x12"x6" Oval (10.1x25.4x10.1 cm) x8"(20.3cm) long pipe
OSTH6104	Galv. Oval Stackhead Boot, 6"x10"x4" Oval (10.1x25.4x10.1 cm) x8"(20.3cm) long pipe
OSTH6105	Galv. Oval Stackhead Boot, 6"x10"x5" Oval (10.1x25.4x10.1 cm) x8"(20.3cm) long pipe
OSTH6106	Galv. Oval Stackhead Boot, 6"x10"x6" Oval (10.1x25.4x10.1 cm) x8"(20.3cm) long pipe
OSTH6107	Galv. Oval Stackhead Boot, 6"x10"x7" Oval (10.1x25.4x10.1 cm) x8"(20.3cm) long pipe
OSTH6126	Galv. Oval Stackhead Boot, 6"x12"x6" Oval (10.1x25.4x10.1 cm) x8"(20.3cm) long pipe
OSTH6127	Galv. Oval Stackhead Boot, 6"x12"x7" Oval (10.1x25.4x10.1 cm) x8"(20.3cm) long pipe

### Performance Data

For galvanized, Oval Stackhead

#### Material

- galvanized steel
- thickness - 32ga. to 30ga.

#### Manufactured

- Dimple lock construction
- Manufactured with various lengths, and gauges

### General Information

- Allows ducting to fit between 2x4" wall studs
- Built-in wings for easy attachment to studs
- Creates transition from stack duct to register
- SMACNA approved
- Oval replaces rectangular wall stack

Size	"A"	Physical Comparison to Wall Stack
4" oval	5"	---
5" oval	6"	3 1/4" x 8"
6" oval	7 9/16"	3 1/4" x 10"
7" oval	9 1/8"	3 1/4" x 12"

For sizing Calculations see ACCA Manual D

